



# GFM 3.0

**The Gas Flow Meter 3.0 is the next generation of High Volume Sampler designed for EPA Compliance and manufactured exclusively by Addglobe, LLC. Inspired by 17 years of high flow sampling experience, the GFM 3.0 is a modern device developed for quantitative measurement of flammable gas leaks.**





# GFM 3.0 Highlights

Gas Flow Meter 3.0 is a portable, explosion-proof, battery-powered instrument designed to measure the volumetric leak rate from various pipe fittings, compressor rod packing, wet/dry seals (off turbine compressors), main line suction and discharge valves, blowdown valves, pressure relief valves, emergency shutdown valves, storage tanks, vents and all other pipe connectors typically found at natural gas facilities.

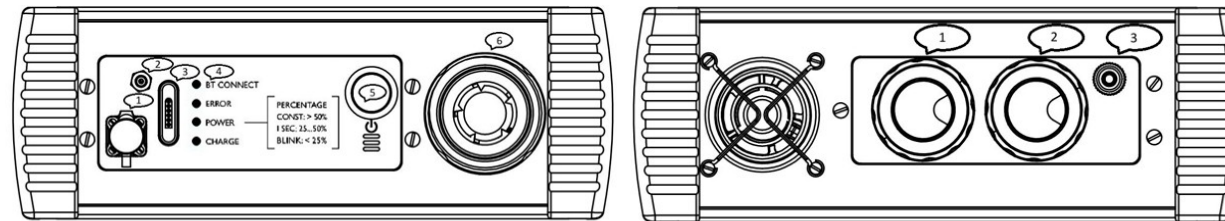

- 1. Battery charge connector
- 2. Direct inlet
- 3. USB connector

- 4. LED indicator panel
- 5. On/Off button
- 6. Main suction inlet

- 1. Working leak-channel filter
- 2. Direct inlet filter
- 3. Ground connector



The GFM 3.0 can quantify approximately 98-99% of fugitive methane emissions at a typical natural gas compressor station or similar facility. The leak rate is measured by high-speed sampling to capture all gas escaping from the source while it is diluted with ambient air. Accurate measurement of both the sample flow rate and the natural gas concentration enables calculation of the leakage rate.

GFM 3.0 is controlled wirelessly using an Android phone (version 6.0 or higher) that displays technical information and supervises the GFM sampler. Reception distance up to 5 meters.



# GFM 3.0 Highlights

Based on our experience we included accessories that are necessary for work in the field and indoors with an optimal performance according to the needs of the industry.

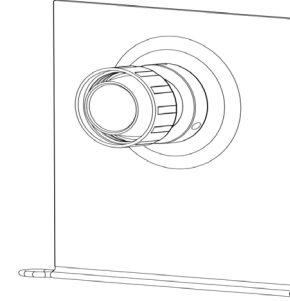
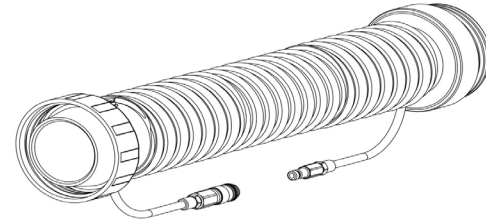

**Hose.** To the hose ( length - 6.0 ft ) to connect instrument to different attachments for different type of leak source.

**Capturing bag.** This fixture is used to catch leaks from various fittings.

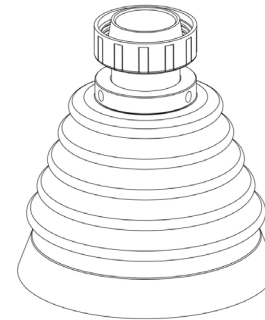

**Corrugated tip.** This tool is useful for catching leaks on valve stems and small fittings.

# GFM 3.0 Highlights



The sampler is installed in a case that can be attached to a special harness, leaving the operator's hands free to perform measurements. There became no apparent use for the harness with the sampler.

Changeable external filters added to prevent contamination of the instrument channels

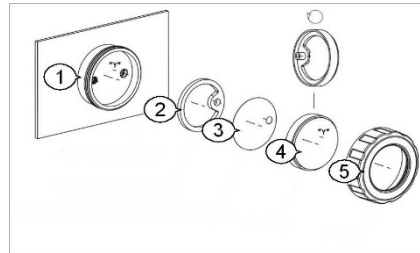

The **External filter** contains the following elements:

1. Filter base;
2. O-ring;
3. Filter element;
4. Clip;
5. Washer.

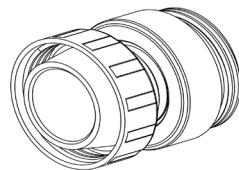

**Coarse filter.** The coarse filter is used to prevent coarse debris from entering the sampling channel.





# GFM 2.0, Basic Specifications

GFM 2.0	
<b>Weight</b>	13.1 lbs. / 5.96 kg
<b>Dimensions</b>	11.4" x 11.2" x 4" / 29cm x 28.5cm x 10cm
<b>Material of the body</b>	High strength aluminum
<b>Working temperature range</b>	From -20° C / -4° F to +50° C / 122° F
<b>Operating time/Charge time/Battery material</b>	10 hours (in cyclic operation) / 10 hours / Li-Pol (without memory effect)
<b>Duration of work in standby mode</b>	72 hours, current consumption 170 mA
<b>Interfaces for communication with external devices</b>	Bluetooth, USB
<b>Memory capacity (number of measurements)</b>	Cyclic buffer capable of recording 50 hours of full technical data (30,000 records). Number of measurements recorded limited only by the memory of external device (phone, tablet)
<b>Lower threshold for detecting/measuring leakage</b>	0.00722 l/min
<b>Upper limit of leakage measurement</b>	350,0 l/min



## Contact Details:

**AddGlobe, LLC**  
**1650 Arabian Drive, Loxahatchee, FL 33470**  
**Phone: (561) 657-9522**  
**Web: [addglobe.com](http://addglobe.com)**  
**E-mail: [info@addglobe.com](mailto:info@addglobe.com)**